

Vineland Veteran's Memorial Home

Vineland, New Jersey

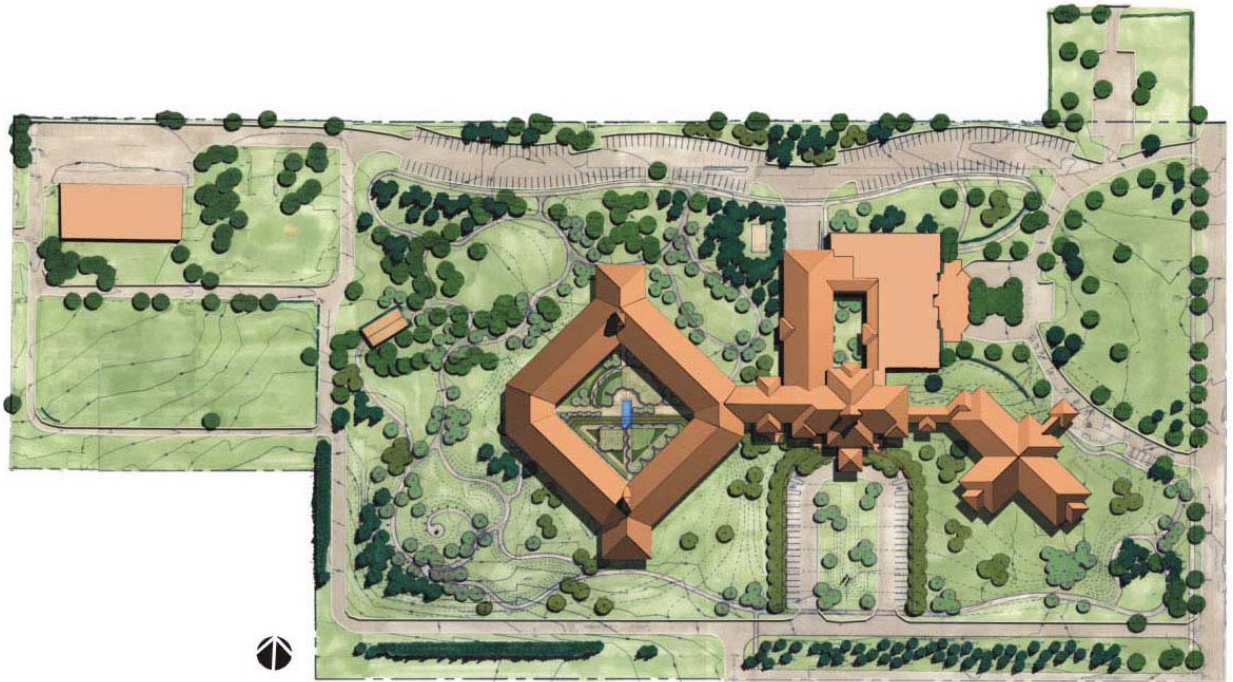

Vineland Veterans Memorial Home, a 27 acre Veterans Administration complex in Vineland, NJ provides skilled nursing care and housing for retired and disabled veterans. The entire campus underwent a six year renovation which included the removal of all but one of the existing buildings, and the construction of a brand new state-of-the-art care facility designed by NK Architects, LLC.



Davies Associates Landscape Architects, LLC (DALA), prepared a master plan of the entire campus and developed detailed site designs for numerous areas within the complex including a park-like setting appropriate for picnicking, viewing and strolling, therapeutic gardening areas for veterans, and outdoor terraces for sitting and socializing. A large bi-level courtyard in the center of the building includes a sculptural waterfall, trees for shade, benches, tables, and lush plantings which add seasonal color.

The grounds also include a memorial garden featuring a spiral walk along which are displayed monuments that were once scattered across the campus. All paths, sitting areas, and views are defined by plantings and custom bollards.

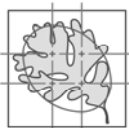

Davies Associates Landscape Architects, LLC

364 Parsippany Road, Suite 7B Parsippany, New Jersey 07054 T. 973.206.1605 F. 973.206.1606 www.bjdavies.com

Vineland Veteran's Memorial Home

Vineland, New Jersey

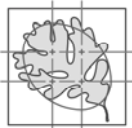

Davies Associates Landscape Architects, LLC

364 Parsippany Road, Suite 7B Parsippany, New Jersey 07054 T. 973.206.1605 F. 973.206.1606 www.bjdavies.com